

The Third Evolution™

Programmable, **RGB**-backlit
LCD Push-button Switches

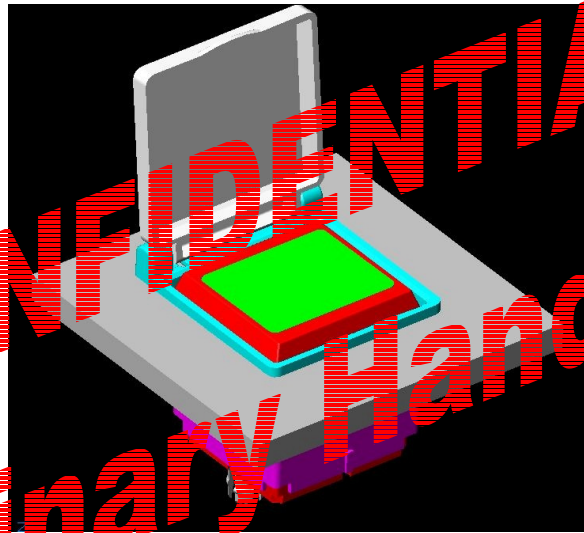

CONFIDENTIAL
Preliminary Handbook

*SG0000 Switch Guard
for Sxnnnn*

intentionally left blank

Table of Contents

Table of Contents	3
SG0000	5
Drawings.....	5
Installation.....	5
Contact Information	6

intentionally left blank

SG0000

SG0000 is a panel-mountable switch guard for Sxnnnn switches from [E³] Engstler Elektronik Entwicklung. The SG0000 switch guard prevent unintentional operation of the Sxnnnn switches by installing a cover over the switch keycap. In order to operate the Sxnnnn switches, the SG0000 switch guard must first be manually opened.

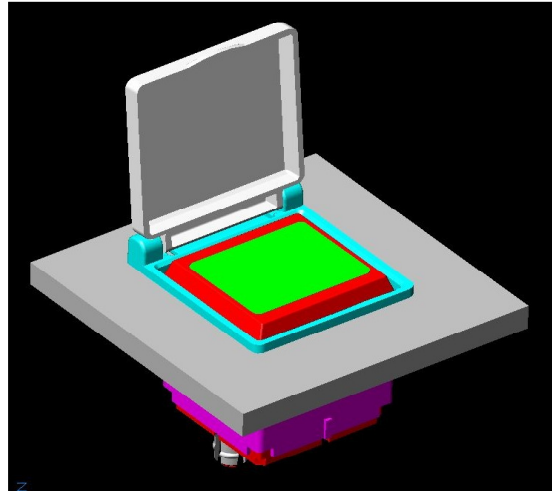

Drawings

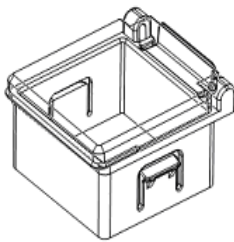

3-D View

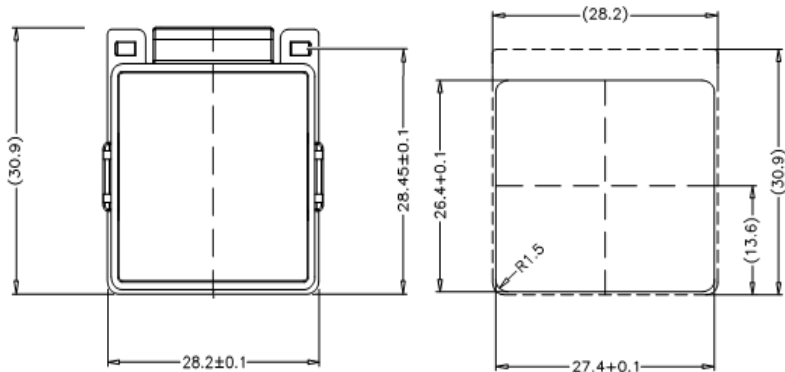

Top View

Panel Cutout

Installation

Cutout Dimensions (X – Y): 27.4+0.1 mm x 26.4+0.1 mm

Frame Thickness: 4.0 -0.05 mm

Mounting: Snap-in front insert

Dismount: depress latches with flat-head screwdriver from back and remove switch guard housing to front

Contact Information

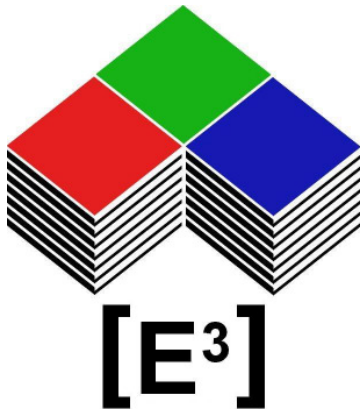

[E³]
**Engstler
Elektronik
Entwicklung
GmbH**

**Industriering 7
63868 Grosswallstadt
Germany**

**Phone: +49 (0) 6022 262570
Fax: +49 (0) 6022 262571
E-Mail: info@e3-keys.com**

